

# STEAM TRAPS



## THERMOSTATIC RADIATOR TRAPS (THE STERLCO SMART TRAP)

### CONSTRUCTION

Trap bodies, covers, union nuts and nipples are close grained red brass castings. Accurate machining assures steam-tight fit and complete interchangeability of parts. Sterlco® low pressure traps, except 715-A, have valve cones of long-wearing tobin bronze and seats of brass. All others have stainless steel cones and seats for maximum resistance to high temperatures and abrasion. Stainless steel cones and seats are available for 1/2" and 3/4" LP traps.

### STERLCO VACUUM THERMOSTAT FEATURES

- Bellows convolutions are formed under extremely high hydraulic pressure
- Smooth bellows surfaces means no tool marks where wear or corrosion can start.
- Multiple convolutions provide free travel of the valve cone. There is no danger of failures due to excessive bellows flexing.
- Vacuum charged...not charged at atmospheric pressure. The trap will close immediately if damaged.

### THE STERLCO SMART TRAP

Will operate efficiently regardless of steam pressure variation. All thermostats and seats are replaceable without shimming or adjustment. Every trap is thoroughly tested. Components are inspected and tested during manufacture; completed traps undergo complete operating tests before shipment.



#### Angle Pattern

750 Series for low pressure; M-7 Series for medium pressure; 8 Series for high pressure



#### Straightway Pattern

Provides minimum loss of height on horizontal piping



#### Vertical Pattern

780 Series for vertical piping and convectors

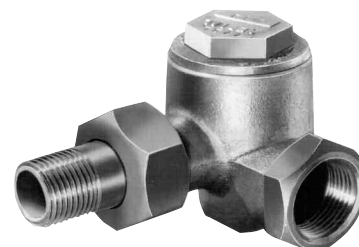

#### Corner Pattern

770 Series for low pressure heating. In right hand and left hand styles for convenient installation

## THERMOSTATIC RADIATOR TRAPS DIMENSIONS AND CAPACITIES

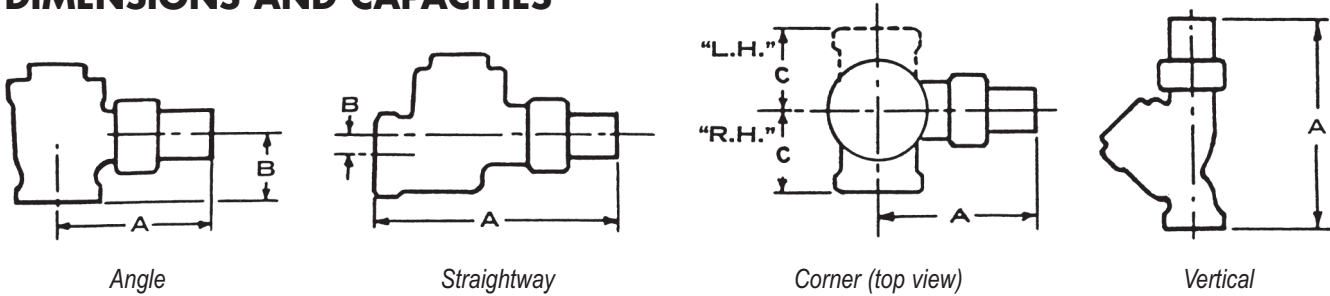

### DIMENSIONS AND CAPACITIES

Pressure Rating Lbs./Sq. In.	Inlet and Outlet Size (Am. Std. Pipe Thd.)	Model	Body Style	Dimensions			Capacity in lbs./hr at Pressure Differentials Indicated						
				A	B	C	1/4 lb.	1/2 lb.	1 lb.	2 lb.	5 lb.	10 lb.	15 lb.
0-25 Low Pressure	1/2"	750-A	Angle	3 1/4*	1 1/4		85	120	165	235	370	530	640
		770-R	R.H. Corner	3 1/4*	3/8	1 5/8							
		770-L	L.H. Corner	3 1/4*	3/8	1 5/8							
		770-S	Straightway	4 7/8*	3/8								
		780-V	Vertical	5*									
	3/4"	753-A	Angle	3 1/8*	1 1/4		165	230	330	465	730	1050	1300
		773-S	Straightway	5 1/4*	3/8								
1"	715-A	Angle	3 1/4*	1 5/8		290	410	580	810	1280	1840	2300	

Note: Above ratings are in accordance with the standards of the Steam Heating Equipment Manufacturers Association. Since actual test capacities are from two to four times these ratings, traps may be selected directly from the table for the lowest pressure differential expected.

Pressure Rating, Lbs./Sq. In.	Inlet and Outlet Size (Am. Std. Pipe Thd.)	Model	Body Style	Dimensions		Capacity in lbs./hr at Pressure Differentials Indicated								
				A	B	5 lb.	10 lb.	15 lb.	25 lb.	50 lb.	65 lb.	75 lb.	100 lb.	125 lb.
0-75 Med. Pressure	1/2"	M-750-A	Angle	3 1/4*	1 1/4	525	780	985	1340	2020	2175	-	-	-
	3/4"	M-753-A		3 1/8*	1 1/4	585	1040	1405	1670	2390	2490	-	-	-
	1"	M-715-A		3 1/4	1 5/8	710	1300	1900	2715	4130	4690	-	-	-
0-125 High Pressure	1/2"	850-A	Angle	3 1/4*	1 1/4	400	640	935	1240	1750	1965	2080	2280	2400
	3/4"	853-A		2 3/4	1 1/4	510	900	1400	1900	2500	2720	2850	3100	3340
	1"	812-A		3 1/4	1 5/8	710	1300	1900	2715	4130	4690	4940	5385	5720

\* Available with tail pieces to reduce or increase "A" dimension by 3/8 inch.

Sterlco® thermostatic radiator traps accurately and efficiently free radiators of air and condensate... without allowing steam to be wasted into returns. They are especially effective on vacuum heating systems. Their simple design and rugged construction assure long, dependable service.