

KUNKLE SAFETY AND RELIEF PRODUCTS

MODELS 6252 AND 6254

ASME Section I Steam and ASME Section VIII, Air, Steam and Gas "UV" National Board Certified.

Model 6254 ASME Section IV "HV," National Board Certified. PED Certified for Non-Hazardous Gas.

Model descriptions

Model 6252: Cast iron, enclosed spring, SS trim.

Model 6254: Same as model 6252 except certified for ASME Code Section IV - Low pressure steam heating boilers. Set 15 psig [1.0 barg] only. J through P orifice only.

Features

- Heavy duty construction of high quality cast iron with Stainless Steel (SS) semi-nozzle trim and disc.
- Bolted bonnet design for easy maintenance.
- Seats lapped to optical flatness.
- Dual control rings offer easy adjustability for precision opening with minimum preopen or simmer and exact blowdown control.
- Heavy duty lift lever assembly.
- All adjustments are factory sealed to prevent tampering or disassembly.
- Each Kunkle valve is tested and inspected for pressure setting and leakage.

Technical data
Pressure and Temperature Limits
Model 6252:

10 to 250 psig [0.7 to 17.2 barg]
-20° to 406°F [-28° to 208°C]

Note:

1. ASME Code valves made from cast iron; A126 may not be used in lethal or flammable service.

Applications

- Steam boilers and generators.
- Pressure reducing stations.
- Air/gas compressors - reciprocating or rotary.
- Pressure vessels - including tanks, receivers, intercoolers, oil/gas separators, lines.

Code:

KUNKLE SAFETY AND RELIEF PRODUCTS

MODELS 6252 AND 6254

Parts and Materials

Models 6252 and 6254		
No.	Part Name	Material
1	Body	Cast Iron, A126 CL A or B
2	Semi Nozzle	SS, SA351 CF8M ⁵
3	Warn Ring Locking Screw	Brass, B16 H02
4	Warn Ring Locking Pin	SS, A582 TY 416
5	Guide	Bronze, B584 C84400
6	Guide Locking Screw	Brass, B16 H02
7	Guide Locking Pin	SS, A582 TY 416
8	Stem End	SS, A582 TY 416
9	Spring Step	Brass, B16 H02
10	Compression Screw	Brass, B16 H02
11	Lever	Iron, A536 65 45 12
12	Compression Screw Lock Nut	SS, SA479 316 SS
13	Lifting Disc Nut	Steel, A108 1018
14	Cap	Iron, A536 65 45 12
15	Lifting Disc	SS, SA479 316 SS
16	Lever Pin	Steel, A108 1018
17	Lever Pin Washer	Steel, A108 1018
18	Lever Cotter Pin	Steel, A108 1018
19	Stem	SS, A582 TY 416
20	Cap Set Screw	Steel, A108 1018
21	Bonnet	Cast Iron, A126 CL A or B
22	Spring	Steel, A229, Aluminum Coated ²
23	Bonnet Bolt	Steel, A193-B7/194-7
24	Disc	SS, SA479 316 SS ⁶
25	Warn Ring	Bronze, B584-C84400 ³
26	Gag Screw ⁴	Steel, A108 1018
27	Wire Seal	Lead Seal, Aluminum Wire ¹
28	Retainer Nut	Brass, B16-H02
29	O-Ring	EPDM
30	Drainhole	3/8" NPT

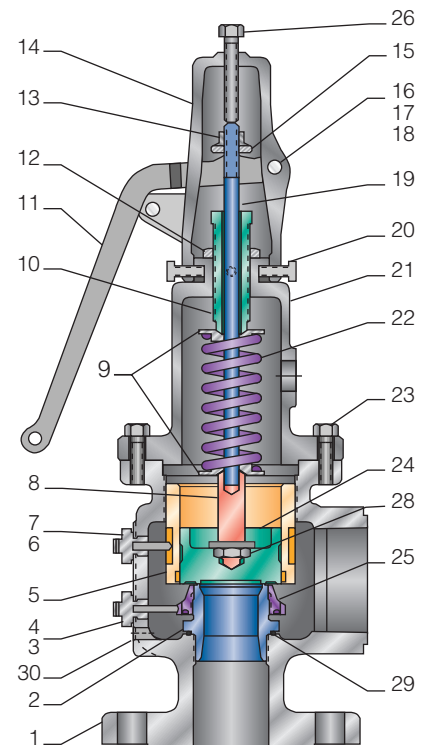

Notes:

1. Not shown on assembly.
2. SS A313-631 for "J" orifice.
3. Brass B16-H02 for "J" orifice.
4. Optional.
5. SS-SA479-316 for "N" and "P" orifice.
6. SS-SA351-C8FM for "Q" and "R" orifice.

KUNKLE SAFETY AND RELIEF PRODUCTS

MODELS 6252 AND 6254

Dimensions

Models 6252 and 6254												
Model ¹	Orifice	Connections		Valve Dimensions						Approximate Weight		
		ANSI Standard, in [mm]		A		B		C		lb	[kg]	
		Inlet ²	Outlet ³									
625*AJG	J	1½ [38.1] FPT	2½ [63.5] FPT	4¼ [108.0]	3½ [88.9]	18	[457.2]	40	[18.2]			
625*FJG	J	1½ [38.1] F	2½ [63.5] FPT	4¼ [108.0]	3½ [88.9]	18	[457.2]	40	[18.2]			
625*FJH	J	2 [50.8] F	2½ [63.5] FPT	4¼ [108.0]	3½ [88.9]	18	[457.2]	42	[19.1]			
625*FJJ	J	2½ [63.5] F	2½ [63.5] FPT	4¼ [108.0]	3½ [88.9]	18	[457.2]	45	[20.5]			
625*AKH	K	2 [50.8] FPT	3 [76.2] FPT	4⅝ [117.6]	4 [101.6]	18¼ [463.6]		43	[19.5]			
625*FKH	K	2 [50.8] F	3 [76.2] FPT	4⅝ [117.6]	4 [101.6]	18¼ [463.6]		52	[23.6]			
625*FKJ	K	2½ [63.5] F	3 [76.2] FPT	4⅝ [117.6]	4 [101.6]	18¼ [463.6]		52	[23.6]			
625*FKK	K	3 [76.2] F	3 [76.2] FPT	4⅝ [117.6]	4 [101.6]	18¼ [463.6]		55	[25.0]			
625*ALJ	L	2½ [63.5] FPT	4 [101.6] FPT	5½ [139.7]	4 ¹³ / ₁₆ [122.2]	21½ [546.1]		74	[33.6]			
625*FLJ	L	2½ [63.5] F	4 [101.6] FPT	5½ [139.7]	4 ¹³ / ₁₆ [122.2]	21½ [546.1]		82	[37.3]			
625*FLK	L	3 [76.2] F	4 [101.6] FPT	5½ [139.7]	4 ¹³ / ₁₆ [122.2]	21½ [546.1]		86	[39.1]			
625*FLM	L	4 [101.6] F	4 [101.6] FPT	5½ [139.7]	4 ¹³ / ₁₆ [122.2]	21½ [546.1]		97	[44.1]			
625*AMK	M	3 [76.2] FPT	4 [101.6] FPT	5⅝ [142.7]	5⅛ [130.0]	21 ¹¹ / ₁₆ [550.9]		90	[40.9]			
625*FMK	M	3 [76.2] F	4 [101.6] FPT	5⅝ [142.7]	5⅛ [130.0]	21 ¹¹ / ₁₆ [550.9]		100	[45.5]			
625*FMM	M	4 [101.6] F	4 [101.6] FPT	5⅝ [142.7]	5⅛ [130.0]	21 ¹¹ / ₁₆ [550.9]		107	[48.6]			
625*KNM	N	4 [101.6] F	6 [152.4] F	6¾ [171.5]	7¼ [184.2]	22½ [571.5]		197	[89.5]			
625*KPM	P	4 [101.6] F	6 [152.4] F	6¾ [171.5]	7¼ [184.2]	25 ¹³ / ₁₆ [655.6]		197	[89.5]			
625*KQP	Q	6 [152.4] F	8 [203.2] F	9¼ [234.9]	10 [254.0]	39⅛ [993.8]		493	[224.0]			
625*KRP	R	6 [152.4] F	8 [203.2] F	9¼ [234.9]	10 [254.0]	39⅛ [993.8]		507	[230.0]			

Dimensions are for reference only.

Notes:

1. Replace asterisk with desired model number.
2. Inlet Flanges are ANSI B16. 1-250#.
3. Outlet Flanges are ANSI B16. 1-125#.

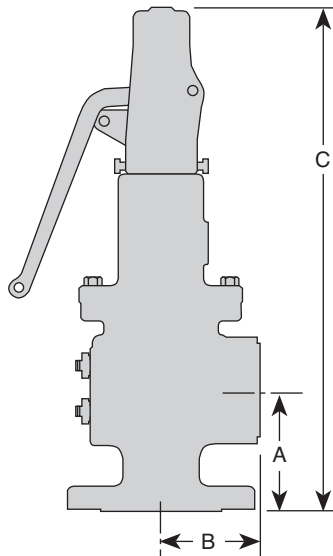

KUNKLE SAFETY AND RELIEF PRODUCTS

MODELS 6252 AND 6254

Capacities for Model 6252

Non-code ¹ and ASME Section VIII Air, (U.S., SCFM) Flow Coefficient = 0.878								
Set Pressure (psig)	Orifice, Area in ²							
	J (1.414)	K (2.022)	L (3.138)	M (3.960)	N (4.774)	P (7.018)	Q (12.155)	R (17.600)
10	582	833	1292	1631	1966	3129	5005	7247
15	744	1064	1652	2084	2513	3694	6397	9263
20	858	1227	1904	2403	2897	4258	7375	10679
25	972	1390	2157	2722	3281	4823	8354	12096
30	1086	1552	2409	3040	3665	5388	9332	13512
35	1211	1731	2687	3391	4088	6009	10408	15070
40	1336	1910	2965	3741	4510	6630	11484	16628
45	1461	2089	3242	4092	4933	7252	12560	18186
50	1586	2268	3520	4442	5356	7873	13636	19744
55	1711	2447	3798	4793	5778	8494	14712	21302
60	1837	2626	4076	5143	6201	9115	15788	22860
65	1962	2805	4354	5494	6623	9737	16864	24418
70	2087	2984	4631	5845	7046	10358	17939	25976
75	2212	3163	4909	6195	7469	10979	19015	27534
80	2337	3342	5187	6546	7891	11600	20091	29092
90	2588	3700	5742	7247	8736	12843	22243	32208
100	2838	4058	6298	7948	9582	14085	24395	35324
110	3088	4416	6854	8649	10427	15328	26547	38440
120	3339	4774	7409	9350	11272	16570	28699	41555
130	3589	5132	7965	10051	12117	17813	30851	44671
140	3839	5490	8520	10752	12962	19055	33003	47787
150	4090	5848	9076	11453	13808	20298	35155	50903
160	4340	6206	9631	12154	14653	21540	37307	54019
170	4590	6564	10187	12855	15498	22783	39459	57135
180	4841	6922	10743	13557	16343	24025	41611	60251
190	5091	7280	11298	14258	17188	25268	43763	63367
200	5341	7638	11854	14959	18034	26510	45915	66483
210	5592	7996	12409	15660	18879	27753	48067	69599
220	5842	8354	12965	16361	19724	28995	50219	72715
230	6092	8712	13520	17062	20569	30238	52371	75831
240	6343	9070	14076	17763	21414	31480	54523	78947
250	6593	9428	14631	18464	22260	32723	56675	82063

Note:

1. No code stamp or "NB" on nameplate below 15 psig set.

KUNKLE SAFETY AND RELIEF PRODUCTS

MODELS 6252 AND 6254

Capacities for Model 6252

Non-code ¹ and ASME Section VIII Steam, [Metric, kg/h] Flow Coefficient = 0.878								
Set Pressure [barg] J	Orifice, Area cm ²							
	K [9.123]	L [13.045]	M [20.245]	N [25.548]	P [30.800]	Q [45.277]	R [78.419]	[113.548]
1.0	945	1350	2095	2644	3164	4685	8115	11750
1.5	1145	1635	2538	3203	3834	5676	9831	14235
2.0	1356	1936	3005	3792	4539	6720	11638	16852
2.5	1585	2263	3512	4431	5304	7854	13602	19696
3.0	1816	2593	4025	5079	6080	9001	15590	22574
3.5	2048	2924	4538	5727	6855	10149	17578	25453
4.0	2279	3255	5051	6375	7630	11297	19567	28332
4.5	2511	3586	5565	7022	8406	12445	21555	31210
5.0	2743	3916	6078	7670	9181	13593	23543	34089
5.5	2974	4247	6591	8318	9956	14741	25531	36968
6.0	3206	4578	7104	8965	10731	15889	27519	39846
6.5	3437	4909	7618	9613	11507	17037	29507	42725
7.0	3669	5239	8131	10261	12282	18185	31495	45604
7.5	3901	5570	8644	10909	13057	19332	33483	48483
8.0	4132	5901	9157	11556	13833	20480	35471	51361
8.5	4364	6231	9671	12204	14608	21628	37459	54240
9.0	4595	6562	10184	12852	15383	22776	39448	57119
9.5	4827	6893	10697	13499	16158	23924	41436	59997
10.0	5059	7224	11211	14147	16934	25072	43424	62876
10.5	5290	7554	11724	14795	17709	26220	45412	65755
11.0	5522	7885	12237	15443	18484	27368	47400	68633
11.5	5753	8216	12750	16090	19260	28515	49388	71512
12.0	5985	8546	13264	16738	20035	29663	51376	74391
12.5	6217	8877	13777	17386	20810	30811	53364	77270
13.0	6448	9208	14290	18033	21585	31959	55352	80148
13.5	6680	9539	14803	18681	22361	33107	57341	83027
14.0	6912	9869	15317	19329	23136	34255	59329	85906
14.5	7143	10200	15830	19976	23911	35403	61317	88784
15.0	7375	10531	16343	20624	24687	36551	63305	91663
15.5	7606	10862	16856	21272	25462	37699	65293	94542
16.0	7838	11192	17370	21920	26237	38846	67281	97420
17.2	8394	11986	18601	23474	28098	41601	72052	104329

Note:

1. No code stamp or "NB" on nameplate below 1.1 barg set.

KUNKLE SAFETY AND RELIEF PRODUCTS

MODELS 6252 AND 6254

Capacities for Model 6252

Non-code¹ and ASME Section VIII Steam, (U.S., lb/h) Flow Coefficient = 0.878

Set Pressure (psig)	Orifice, Area in ²							
	J (1.414)	K (2.022)	L (3.138)	M (3.960)	N (4.774)	P (7.018)	Q (12.155)	R (17.600)
10	1775	2538	3938	4970	5991	8807	15254	22087
15	2091	2990	4640	5855	7059	10377	17972	26023
20	2410	3447	5349	6751	8138	11963	20720	30002
25	2730	3904	6059	7646	9217	13550	23468	33981
30	3050	4361	6768	8541	10297	15137	26217	37961
35	3401	4864	7549	9526	11484	16882	29239	42338
40	3753	5367	8329	10511	12671	18627	32262	46715
45	4105	5870	9109	11496	13859	20373	35285	51092
50	4456	6373	9890	12480	15046	22118	38308	55469
55	4808	6875	10670	13465	16233	23863	41331	59846
60	5160	7378	11451	14450	17420	25609	44354	64223
65	5511	7881	12231	15435	18608	27354	47377	68600
70	5863	8384	13011	16420	19795	29099	50399	72977
75	6215	8887	13792	17405	20982	30845	53422	77354
80	6566	9390	14572	18389	22169	32590	56445	81731
90	7270	10395	16133	20359	24544	36081	62491	90485
100	7973	11401	17694	22329	26918	39571	68537	99239
110	8676	12407	19255	24298	29293	43062	74582	107993
120	9380	13413	20815	26268	31668	46553	80628	116747
130	10083	14418	22376	28238	34042	50043	86674	125501
140	10786	15424	23937	30207	36417	53534	92720	134255
150	11489	16430	25498	32177	38791	57025	98765	143009
160	12193	17435	27059	34147	41166	60515	104811	151763
170	12896	18441	28619	36116	43540	64006	110857	160517
180	13599	19447	30180	38086	45915	67497	116903	169271
190	14303	20453	31741	40056	48289	70987	122948	178025
200	15006	21458	33302	42025	50664	74478	128994	186779
210	15709	22464	34863	43995	53038	77969	135040	195533
220	16413	23470	36423	45965	55413	81459	141086	204287
230	17116	24475	37984	47934	57787	84950	147131	213041
240	17819	25481	39545	49904	60162	88441	153177	221795
250	18523	26487	41106	51873	62536	91931	159223	230549

Note:

1. No code stamp or "NB" on nameplate below 15 psig set.

KUNKLE SAFETY AND RELIEF PRODUCTS

MODELS 6252 AND 6254

Capacities for Model 6252

Non-code ¹ and ASME Section VIII Air, [Metric, Nm ³ /h] Flow Coefficient = 0.878								
Set Pressure [barg]	Orifice, Area cm ²							
	J [9.123]	K [13.045]	L [20.245]	M [25.548]	N [30.800]	P [45.277]	Q [78.419]	R [113.548]
1.0	1148	1639	2543	3210	3842	5688	9852	14265
1.5	1445	2063	3201	4040	4836	7160	12400	17955
2.0	1710	2442	3790	4783	5725	8476	14680	21256
2.5	1999	2854	4429	5590	6691	9906	17157	24842
3.0	2291	3271	5077	6407	7668	11354	19664	28473
3.5	2583	3688	5724	7224	8646	12802	22172	32104
4.0	2875	4106	6371	8040	9624	14250	24680	35735
4.5	3167	4523	7019	8857	10602	15697	27187	39366
5.0	3459	4940	7666	9674	11580	17145	29695	42997
5.5	3751	5357	8314	10491	12558	18593	32203	46628
6.0	4044	5774	8961	11308	13536	20041	34710	50259
6.5	4336	6191	9608	12125	14514	21489	37218	53890
7.0	4628	6608	10256	12942	15492	22937	39726	57521
7.5	4920	7026	10903	13759	16469	24384	42233	61152
8.0	5212	7443	11551	14576	17447	25832	44741	64783
8.5	5504	7860	12198	15393	18425	27280	47249	68414
9.0	5796	8277	12845	16210	19403	28728	49756	72045
9.5	6088	8694	13493	17027	20381	30176	52264	75676
10.0	6381	9111	14140	17844	21359	31624	54772	79307
10.5	6673	9528	14787	18661	22337	33072	57279	82938
11.0	6965	9946	15435	19478	23315	34519	59787	86569
11.5	7257	10363	16082	20295	24293	35967	62294	90200
12.0	7549	10780	16730	21112	25270	37415	64802	93831
12.5	7841	11197	17377	21929	26248	38863	67310	97462
13.0	8133	11614	18024	22746	27226	40311	69817	101093
13.5	8426	12031	18672	23563	28204	41759	72325	104724
14.0	8718	12449	19319	24380	29182	43207	74833	108355
14.5	9010	12866	19967	25197	30160	44654	77340	111986
15.0	9302	13283	20614	26014	31138	46102	79848	115617
15.5	9594	13700	21261	26831	32116	47550	82356	119248
16.0	9886	14117	21909	27648	33094	48998	84863	122879
17.2	10587	15118	23462	29608	35440	52473	90882	131593

Note:

1. No code stamp or "NB" on nameplate below 1.1 barg set.

KUNKLE SAFETY AND RELIEF PRODUCTS

MODELS 6252 AND 6254

Capacities for Model 6252

Non-code and ASME Section I Steam, (U.S., lb/h) Flow Coefficient = 0.878								
Set Pressure (psig)	Orifice, Area in ²							
	J (1.414)	K (2.022)	L (3.138)	M (3.960)	N (4.774)	P (7.018)	Q (12.155)	R (17.600)
15	2027	2898	4498	5676	6843	10059	17423	25227
20	2346	3355	5207	6571	7922	11646	20171	29207
25	2666	3813	5917	7467	9002	13233	22919	33186
30	2986	4270	6626	8362	10081	14819	25667	37165
35	3306	4727	7336	9257	11160	16406	28415	41144
40	3625	5184	8045	10153	12240	17993	31163	45123
45	3945	5641	8755	11048	13319	19579	33911	49102
50	4265	6098	9464	11943	14398	21166	36659	53081
55	4584	6555	10174	12839	15478	22753	39407	57060
60	4904	7013	10883	13734	16557	24339	42155	61039
65	5224	7470	11592	14629	17636	25926	44903	65018
70	5550	7936	12316	15542	18737	27544	47706	69077
75	5879	8407	13047	16465	19849	29179	50537	73176
80	6208	8878	13778	17387	20961	30813	53367	77274
90	6867	9819	15239	19231	23184	34082	59028	85471
100	7525	10761	16701	21075	25407	37350	64689	93668
110	8184	11703	18162	22920	27631	40619	70350	101865
120	8842	12645	19624	24764	29854	43887	76011	110062
130	9501	13586	21085	26608	32078	47156	81672	118259
140	10160	14528	22546	28453	34301	50424	87333	126456
150	10818	15470	24008	30297	36525	53693	92994	134653
160	11477	16411	25469	32141	38748	56961	98655	142850
170	12135	17353	26931	33985	40971	60230	104316	151046
180	12794	18295	28392	35830	43195	63498	109977	159243
190	13452	19237	29854	37674	45418	66767	115638	167440
200	14111	20178	31315	39518	47642	70035	121300	175637
210	14769	21120	32777	41363	49865	73304	126961	183834
220	15428	22062	34238	43207	52088	76572	132622	192031
230	16087	23003	35700	45051	54312	79841	138283	200228
240	16745	23945	37161	46896	56535	83109	143944	208425
250	17404	24887	38623	48740	58759	86378	149605	216622

KUNKLE SAFETY AND RELIEF PRODUCTS

MODELS 6252 AND 6254

Capacities for Model 6252

Non-code and ASME Section I Steam, [Metric, kg/h] Flow Coefficient = 0.878								
Set Pressure [barg]	Orifice, Area cm ²							
	J [9.123]	K [13.045]	L [20.245]	M [25.548]	N [30.800]	P [45.277]	Q [78.419]	R [113.548]
1.0	904	1293	2007	2533	3054	4489	7775	11257
1.5	1115	1594	2474	3122	3763	5532	9582	13874
2.0	1325	1895	2940	3711	4473	6576	11389	16491
2.5	1535	2195	3407	4299	5183	7619	13197	19108
3.0	1745	2496	3874	4888	5893	8663	15004	21725
3.5	1956	2797	4340	5477	6603	9706	16811	24342
4.0	2166	3097	4807	6066	7313	10750	18619	26959
4.5	2376	3398	5273	6655	8023	11794	20426	29576
5.0	2592	3706	5751	7258	8750	12863	22278	32257
5.5	2808	4016	6232	7864	9481	13937	24139	34953
6.0	3025	4325	6712	8471	10212	15012	26001	37648
6.5	3241	4635	7193	9077	10943	16087	27862	40344
7.0	3458	4945	7674	9684	11674	17162	29724	43039
7.5	3674	5254	8154	10290	12406	18237	31586	45735
8.0	3891	5564	8635	10897	13137	19312	33447	48430
8.5	4107	5874	9115	11503	13868	20386	35309	51126
9.0	4324	6183	9596	12110	14599	21461	37170	53821
9.5	4541	6493	10077	12716	15330	22536	39032	56517
10.0	4757	6803	10557	13323	16061	23611	40893	59212
10.5	4974	7112	11038	13929	16792	24686	42755	61908
11.0	5190	7422	11518	14536	17524	25761	44617	64603
11.5	5407	7732	11999	15142	18255	26835	46478	67299
12.0	5623	8041	12480	15749	18986	27910	48340	69994
12.5	5840	8351	12960	16355	19717	28985	50201	72690
13.0	6057	8661	13441	16962	20448	30060	52063	75385
13.5	6273	8970	13921	17568	21179	31135	53925	78081
14.0	6490	9280	14402	18175	21911	32210	55786	80776
14.5	6706	9590	14883	18781	22642	33284	57648	83472
15.0	6923	9899	15363	19388	23373	34359	59509	86167
15.5	7139	10209	15844	19994	24104	35434	61371	88863
16.0	7356	10519	16324	20601	24835	36509	63233	91558
16.5	7572	10828	16805	21207	25566	37584	65094	94254
17.0	7789	11138	17286	21814	26298	38659	66956	96949
17.2	7876	11262	17478	22056	26590	39089	67700	98028

Capacities for Model 6254

ASME Section IV Steam, (lb/h) [kg/h]						
Set Pressure (psig) [barg]	Orifice, Area in ² [cm ²]					
	J 1.414 [9.123]	K 2.022 [13.045]	L 3.138 [20.245]	M 3.960 [25.548]	N 4.774 [30.800]	P 7.018 [45.277]
15 [1.0]	2217 [1004]	3171 [1436]	4921 [2229]	6210 [2813]	7486 [3391]	11005 [4985]

KUNKLE SAFETY AND RELIEF PRODUCTS

MODELS 6252 AND 6254

Model Number/Order Guide

Model Number Position	1	2	3	4	5	6	7	8	9	10	11	12	13	14	15	16
-----------------------	---	---	---	---	---	---	---	---	---	----	----	----	----	----	----	----

Example	6	2	5	2	F	L	K	0	1	—	A	S	0	0	2	0
---------	---	---	---	---	---	---	---	---	---	---	---	---	---	---	---	---

Model

6252
6254

Connection Type

A - Female x Female
F - 250# Flange x Female
K - 250# Flange x 125# Flange

Orifice

J N
K P
L Q
M R

Inlet Size

G - 1 1/2" [38.1] K - 3" [76.2]
H - 2" [50.8] M - 4" [101.6]
J - 2 1/2" [63.5] P - 6" [152.4]

Variation (01 to 99)

01 - Plain lever
02 - Plain lever with gag

Design Revision

Indicates non-interchangeable revision.
Dash (-) if original design.

Valve Service

A - Steam ASME Section I (Model 6252 only)
G - Steam ASME Section IV Model 6254 only (15 psig) [1.0 barg]
K - Air ASME Section VIII (Model 6252 only)
L - Steam ASME Section VIII (Model 6252 only)
N - Non-code Air/Gas
P - Non-code Steam

Spring Material

S - Steel (plated)

Set Pressure

Model 6252 - 10 psig [0.34 barg] (0005) to 250 psig [17.2 barg] (0250)
Model 6254 - 15 psig [1.0 barg] (0015)



VALVES & CONTROLS

5500 WAYZATA BLVD # 800, MINNEAPOLIS, MN 55416 WWW.PENTAIR.COM/VALVES

KUNKLE FACILITY PHONE: 1-828-669-3700 • WWW.KUNKLEVALVE.COM

All Pentair trademarks and logos are owned by Pentair, Inc. All other brand or product names are trademarks or registered marks of their respective owners. Because we are continuously improving our products and services, Pentair reserves the right to change specifications without prior notice. Pentair is an equal opportunity employer.